

Front Chainwheel
FC-M341-S Silver Version
FC-M341-L Black Version

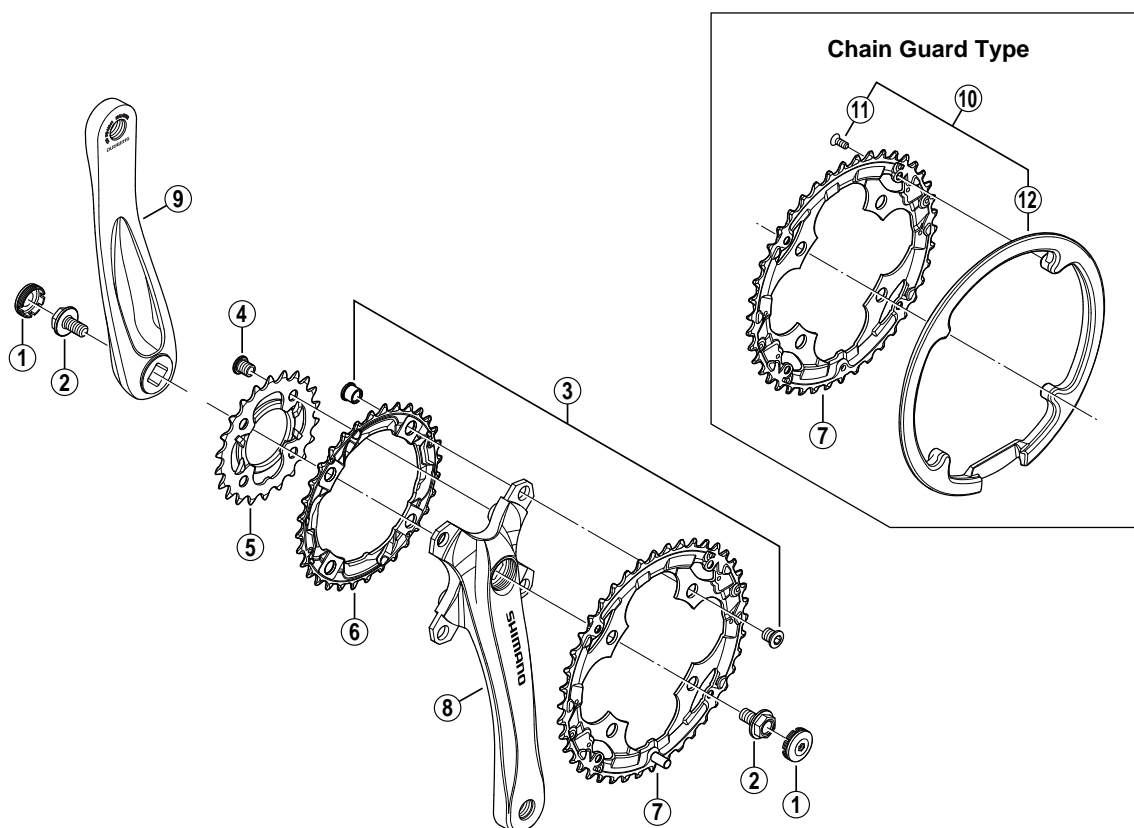

- Chaining teeth combinations: 42-32-22T / 48-38-28T
- Bolt circle diameter: 104 mm...(For outer gear and middle gear), 64 mm...(For inner gear)

ITEM NO.	SHIMANO CODE NO.	DESCRIPTION
1	Y-1A1 11000	Crank Arm Cap (Silver) for FC-M341-S
	Y-1A1 11010	Crank Arm Cap (Black) for FC-M341-L
2	Y-155 07000	Crank Arm Fixing Bolt
* 3	Y-1FM 98020	Double Gear Fixing Bolt (M8 x 8.5) & Nut (4 sets)
* 4	Y-1FM 98030	Inner Gear Fixing Bolt (M8 x 8.5 / 4 pcs.)
5	Y-1GM98010	Chaining 22T (Silver) & Chain Protector
	Y-1GL 98090	Chaining 28T (Silver) & Chain Protector
6	Y-1GM98020	Chainring 32T (Silver)
	Y-1GL 98100	Chainring 38T (Silver)
7	Y-1GU98010	Chainring 42T (Black)
	Y-1GU98020	Chainring 42T (Black) for Chain Guard
	Y-1GL 98110	Chainring 48T (Black)
* 8	Y-1GL 98120	Chainring 48T (Black) for Chain Guard
8	Y-1GU05010	Right Hand Crank Arm 170 mm (Silver) for FC-M341-S
	Y-1GU05000	Right Hand Crank Arm 170 mm (Black) for FC-M341-L
	Y-1GU03010	Right Hand Crank Arm 175 mm (Silver) for FC-M341-S
	Y-1GU03000	Right Hand Crank Arm 175 mm (Black) for FC-M341-L
9	Y-1GU05110	Left Hand Crank Arm 170 mm (Silver) for FC-M341-S
	Y-1GU05100	Left Hand Crank Arm 170 mm (Black) for FC-M341-L
	Y-1GU03110	Left Hand Crank Arm 175 mm (Silver) for FC-M341-S
10	Y-1GU03100	Left Hand Crank Arm 175 mm (Black) for FC-M341-L
	Y-1GM98090	Chain Guard for 42T & Fixing Screws
* 11	Y-1GL 98130	Chain Guard for 48T & Fixing Screws
11	Y-1D2 98010	Chain Guard Fixing Screw (4 pcs.)
	Y-1GM13000	Chain Guard for 42T
* 12	Y-1GL 12000	Chain Guard for 48T

0608-2489B